

 *Aliaxis*



**RACCORDI  
PER SALDATURA DI TESTA**

PP-H

Raccordi serie metrica ISO-UNI

# RACCORDI PER SALDATURA DI TESTA

Serie di raccordi destinati al convogliamento di fluidi in pressione con sistema di giunzione mediante saldatura di testa.

## RACCORDI SERIE METRICA ISO-UNI

Specifiche tecniche	
<b>Gamma dimensionale</b>	d 20 ÷ d 630 (mm)
<b>Pressione nominale</b>	SDR 17, 6 (PN6) con acqua a 20 °C SDR 11 (PN10) con acqua a 20 °C
<b>Campo di temperatura</b>	0 °C ÷ 100 °C
<b>Standard di accoppiamento</b>	<b>Saldatura:</b> EN ISO 15494. Accoppiabili con tubi secondo EN ISO 15494 <b>Flangiatura:</b> ISO 7005-1, EN 1092-1, EN ISO 15494, DIN 2501, ANSI B16.5 cl.150
<b>Riferimenti normativi</b>	<b>Criteri Costruttivi:</b> EN ISO 15494 <b>Metodi e requisiti dei test:</b> EN ISO 15494 <b>Criteri di installazione:</b> DVS 2202-1, DVS 2207-11, DVS 2208-1, UNI 11397
<b>Materiale raccordi</b>	PP-H
<b>Materiali tenuta</b>	EPDM, FKM

# DATI TECNICI

## VARIAZIONE DELLA PRESSIONE IN FUNZIONE DELLA TEMPERATURA

Per acqua o fluidi non pericolosi nei confronti dei quali il materiale è classificato CHIMICAMENTE RESISTENTE (aspettativa di vita 25 anni). In altri casi è richiesta un'adeguata diminuzione della pressione nominale PN.

A = SDR 11 ISO-S5 - 5 anni

B = SDR 11 ISO-S5 - 25 anni

C = SDR 17,6 ISO-S8,3 - 5 anni

D = SDR 17,6 ISO-S8,3 - 25 anni

Pressioni effettive di servizio ammissibili per raccordi di testa in PP-H in accordo a DIN 16962.

Coefficiente di sicurezza=1.7

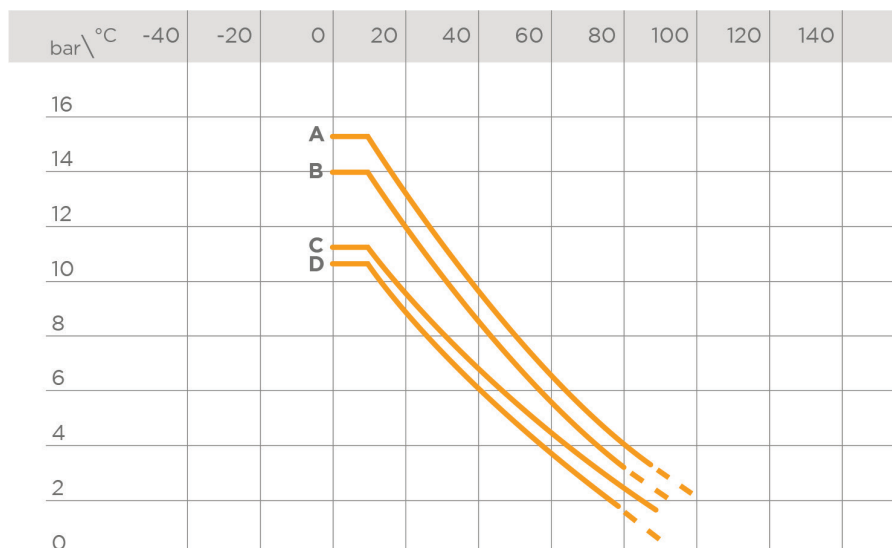

## VARIAZIONE DELLA PRESSIONE IN FUNZIONE DELLA TEMPERATURA

Per acqua o fluidi non pericolosi nei confronti dei quali il materiale è classificato CHIMICAMENTE RESISTENTE (aspettativa di vita 25 anni). In altri casi è richiesta un'adeguata diminuzione della pressione nominale PN.

E = SDR 11 ISO-S5 - 10 anni

F = SDR 11 ISO-S5 - 50 anni

G = SDR 17,6 ISO-S8,3 - 10 anni

H = SDR 17,6 ISO-S8,3 - 50 anni

Pressioni effettive di servizio ammissibili per raccordi di testa in accordo a DIN 16962 e per tubazioni in PP-H in accordo a DIN 8077.

Coefficiente di sicurezza=1.7

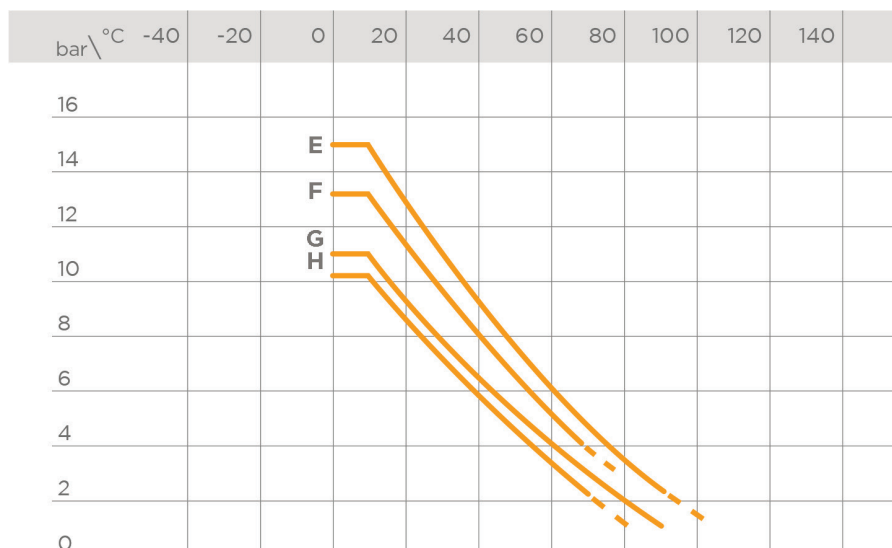

I dati del presente prospetto sono forniti in buona fede. La FIP non si assume alcuna responsabilità su quei dati non direttamente derivati da norme internazionali. La FIP si riserva di apportarvi qualsiasi modifica. L'installazione e la manutenzione del prodotto deve essere eseguita da personale qualificato.

# DIMENSIONI

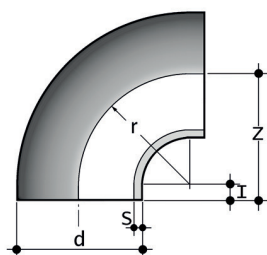

## GBM

Curva a 90° codolo corto per saldatura di testa SDR 17,6 - S 8,3

d	l	r	s	Z	g	Codice SDR 17,6 - S 8,3
50	7	55	2,9	62	47	GBM17050
63	8	69	3,6	77	89	GBM17063
75	10	75	4,3	85	152	GBM17075
90	10	90	5,1	100	245	GBM17090
110	10	110	6,3	120	422	GBM17110
125	15	125	7,1	140	652	GBM17125
140	15	140	8	155	900	GBM17140
160	15	160	9,1	175	1231	GBM17160
180	15	180	10,2	195	1875	GBM17180
200	15	200	11,4	215	2423	GBM17200
225	20	225	12,8	245	3469	GBM17225
250	25	250	14,2	275	4568	GBM17250
280	30	280	15,9	310	6550	GBM17280
315	35	315	17,9	350	9728	GBM17315
355	38	355	20,1	385	19365	GBM17355S
400	41	400	22,7	438	28650	GBM17400S
450	60	450	25,5	510	52551	GBM17450S
500	60	500	28,3	560	28650	GBM17500S

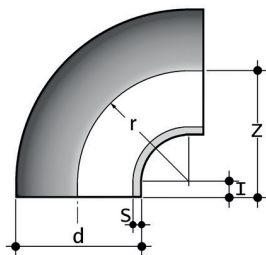

## GBM

Curva a 90° codolo corto per saldatura di testa SDR 11 - S 5

d	l	r	s	Z	g	Codice SDR 11 - S 5
20	3	24	1,9	27	5	GBM11020
25	5	27	2,3	32	9	GBM11025
32	5	35	2,9	40	17	GBM11032
40	7	44	3,7	51	36	GBM11040
50	7	55	4,6	62	66	GBM11050
63	8	69	5,8	77	124	GBM11063
75	10	75	6,8	85	210	GBM11075
90	10	90	8,2	100	355	GBM11090
110	10	110	10	120	616	GBM11110
125	15	125	11,4	140	945	GBM11125
140	15	140	12,7	155	1300	GBM11140
160	15	160	14,6	175	1870	GBM11160
180	15	180	16,4	195	2767	GBM11180
200	15	200	18,2	215	3604	GBM11200
225	20	225	20,5	245	5292	GBM11225
250	25	250	22,7	275	7210	GBM11250
280	30	280	25,4	310	10020	GBM11280
315	35	315	28,6	350	13965	GBM11315
355	38	355	32,2	385	12760	GBM11355S
400	41	400	36,3	438	18500	GBM11400S
450	60	450	40,9	510	18500	GBM11450S
500	60	500	45,4	560	18500	GBM11500S

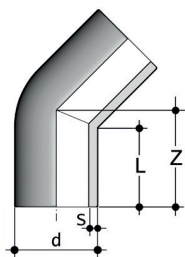

## HBM

Curva a 45° codolo lungo per saldatura di testa SDR 17,6 - 8,3

d	L	Z	s	g	Codice SDR 17,6 - S 8,3
50	62	76	2,9	80	HBM17050S
63	66	88	3,6	142	HBM17063S
75	71	90	4,3	196	HBM17075S
90	82	105	5,1	325	HBM17090S
110	93	121	6,3	560	HBM17110S
125	98	137	7,1	790	HBM17125S
140	120	168	8	1245	HBM17140S
160	143	190	9,1	1850	HBM17160S
180	141	196	10,2	2335	HBM17180S
200	152	207	11,4	3130	HBM17200S
225	153	210	12,8	3970	HBM17225S
250	133	220	14,2	5780	HBM17250S
280	142	227	15,9	7285	HBM17280S
315	155	250	17,9	9850	HBM17315S

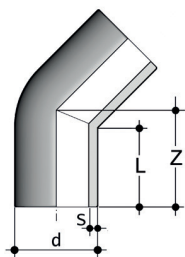

## HBM

Curva a 45° codolo lungo per saldatura di testa SDR 11 - S 5

d	L	Z	s	g	Codice SDR 11 - S 5
20	52	72	1,9	19	HBM11020S
25	57	76	2,3	30	HBM11025S
32	71	90	2,9	56	HBM11032S
40	73	95	3,7	88	HBM11040S
50	62	76	4,6	110	HBM11050S
63	66	88	5,8	205	HBM11063S
75	71	90	6,8	290	HBM11075S
90	83	105	8,2	460	HBM11090S
110	93	121	10	785	HBM11110S
125	98	137	11,4	1130	HBM11125S
140	122	168	12,7	1685	HBM11140S
160	143	190	14,6	2550	HBM11160S
180	141	196	16,4	3285	HBM11180S
200	153	207	18,2	4540	HBM11200S
225	153	210	20,5	5750	HBM11225S
250	134	220	22,7	7875	HBM11250S
280	143	227	25,4	10060	HBM11280S
315	155	250	28,6	13675	HBM11315S

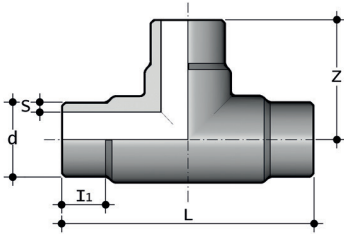

## TBM

Ti a 90° codolo corto per saldatura di testa SDR 17,6 - S8,3

d	I <sub>1</sub>	L	s	Z	g	Codice SDR 17,6 - S 5
50	21	116	2,9	58	80	TBM17050
63	24	146	3,6	73	175	TBM17063
75	28	170	4,3	85	295	TBM17075
90	23	200	5,1	100	480	TBM17090
110	43	240	6,3	120	790	TBM17110
125	26	250	7,1	125	1150	TBM17125
140	32	280	8	140	1455	TBM17140
160	40	320	9,1	160	2170	TBM17160
180	73	390	10,2	195	3315	TBM17180
200	64	430	11,4	215	4600	TBM17200
225	72	490	12,8	245	6530	TBM17225
250	86	550	14,2	275	8145	TBM17250
280	105	620	15,9	310	13000	TBM17280
315	111	700	17,9	350	18375	TBM17315
355	103	690	20,1	345	21900	TBM17355S
400	105	734	22,7	367	26300	TBM17400S
450	138	838	25,5	419	42715	TBM17450S
500	165	954	28,3	477	59500	TBM17500S



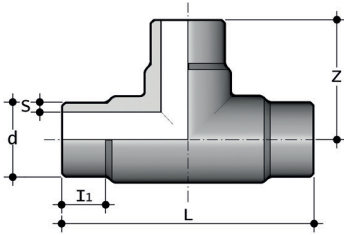

## TBM

Ti a 90° codolo corto per saldatura di testa SDR 11 - S 5

d	I <sub>1</sub>	L	s	Z	g	Codice SDR 11 - S 5
20	8	50	1,9	25	11	TBM11020
25	10	60	2,3	30	15	TBM11025
32	12	80	2,9	40	30	TBM11032
40	16	88	3,7	44	55	TBM11040
50	21	116	4,6	58	115	TBM11050
63	24	146	5,8	73	230	TBM11063
75	28	170	6,8	85	390	TBM11075
90	23	200	8,2	100	645	TBM11090
110	43	240	10	120	1040	TBM11110
125	26	250	11,4	125	1480	TBM11125
140	32	280	12,7	140	2060	TBM11140
160	40	320	14,6	160	2925	TBM11160
180	73	390	16,4	195	4665	TBM11180
200	64	430	18,2	215	6470	TBM11200
225	72	490	20,5	245	9220	TBM11225
250	86	550	22,7	275	12650	TBM11250
280	105	620	25,4	310	18205	TBM11280
315	111	700	28,6	350	25700	TBM11315
355	103	698	32,2	349	30200	TBM11355S
400	105	720	36,3	360	39100	TBM11400S
450	137	838	40,9	419	61129	TBM11450S
500	160	930	45,4	465	84230	TBM11500S

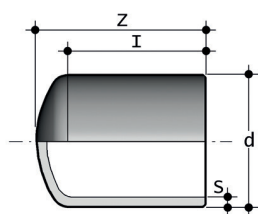

## CBM

Calotta a codolo lungo per saldatura di testa SDR 17,6 - S 8,3

d	I	S	Z	g	Codice SDR 17,6 - S 8,3
63	62	3,6	85	70	CBM17063
75	63	4,3	95	100	CBM17075
90	79	5,1	110	190	CBM17090
110	88	6,3	127	300	CBM17110
125	95	7,1	124	160	CBM17125
140	110	8	140	180	CBM17140
160	121	9,1	152	400	CBM17160
180	134	10,2	169	500	CBM17180
200	140	11,4	184	690	CBM17200
225	160	12,8	200	960	CBM17225
250	160	14,2	230	1500	CBM17250
280	162	15,9	257	2100	CBM17280
315	171	17,9	262	2900	CBM17315
*355	-	20,1	55	4170	CBM17355S
*400	-	22,7	60	5960	CBM17400S
*450	-	25,5	70	8520	CBM17450S
*500	-	28,4	75	11600	CBM17500S
*560	-	31,7	80	16000	CBM17560S
*630	-	35,7	90	22900	CBM17630S
*710	-	40,2	120	33500	CBM17710S
*800	-	45,3	130	47500	CBM17800S

\* codolo corto

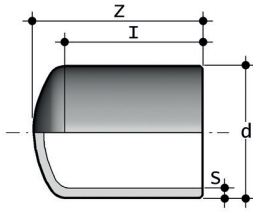

## CBM

Calotta a codolo lungo per saldatura di testa SDR 11 - S 5

d	I	S	Z	g	Codice SDR 11 - S 5
20	35	1,9	45	10	CBM11020
25	40	2,3	52	10	CBM11025
32	44	2,9	58	20	CBM11032
40	50	3,7	67	30	CBM11040
50	55	4,6	75	50	CBM11050
63	62	5,8	85	90	CBM11063
75	63	6,8	95	130	CBM11075
90	79	8,2	110	230	CBM11090
110	88	10	127	400	CBM11110
125	94	11,4	130	520	CBM11125S
140	99	12,7	142	695	CBM11140S
160	109	14,6	162	1040	CBM11160S
180	141	16,4	191	730	CBM11180
200	127	18,2	181	1060	CBM11200
225	129	20,5	205	2625	CBM11225
*250	-	22,7	50	1840	CBM11250S
*280	-	25,4	55	2560	CBM11280S
*315	-	28,6	60	3600	CBM11315S
*355	-	32,2	65	5040	CBM11355S
*400	-	36,3	70	7240	CBM11400S
*450	-	40,9	80	10200	CBM11450S
*500	-	45,4	85	14000	CBM11500S

\* codolo corto

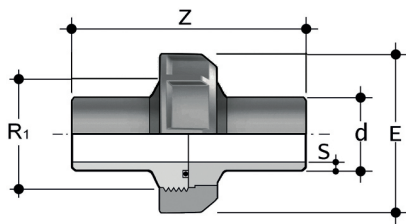

## BBM-L

Bocchettone codolo lungo per saldatura di testa con guarnizione in EPDM o FKM

d	DN	R <sub>1</sub>	E	SDR 11 - S5 S	Z	g	Codice *EPDM	Codice **FKM
20	15	1"	46	1,9	190	70	BBML11020E	BBML11020F
25	20	1"1/4	56	2,3	190	105	BBML11025E	BBML11025F
32	25	1"1/2	66	2,9	190	140	BBML11032E	BBML11032F
40	32	2"	79	3,7	190	210	BBML11040E	BBML11040F
50	40	2"1/4	87	4,6	190	295	BBML11050E	BBML11050F
63	50	2"3/4	107	5,8	190	480	BBML11063E	BBML11063F

\* O-ring in EPDM  
\*\* O-ring in FKM

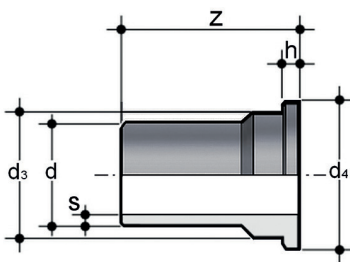

## Q/BBM-L

Pezzo folle codolo lungo per saldatura di testa per bocchettone BBM-L

d	d <sub>3</sub>	d <sub>4</sub>	h	SDR 11 - S5 S Z	Z	g	Codice SDR 11 - S5
20	27,4	30	5	1,9	95	20	QBBML11020
25	35,9	38,7	6	2,3	95	40	QBBML11025
32	41,4	44,6	6	2,9	95	45	QBBML11032
40	52,8	56,4	7	3,7	95	75	QBBML11040
50	58,8	62,5	7	4,6	95	110	QBBML11050
63	73,8	78,3	8	5,8	95	160	QBBML11063
75	83	96,7	9	6,8	130	290	QBBML11075
90	98	109,4	10	8,2	150	357	QBBML11090
110	118	134,8	11	10	170	630	QBBML11110

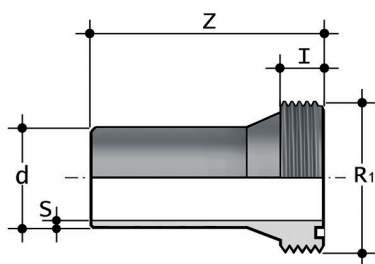

## F/BMM-L

Pezzo fisso codolo lungo per saldatura di testa per bocchettone BBM-L

d	R <sub>1</sub>	I	SDR11 - S 5 S	Z	g	Codice SDR 11 - S 5
20	1"	13	1,9	95	25	FBMML11020
25	1"1/4	13	2,3	95	40	FBMML11025
32	1"1/2	14	2,9	95	50	FBMML11032
40	2"	16	3,7	95	80	FBMML11040
50	2"1/4	18	4,6	95	115	FBMML11050
63	2"3/4	20	5,8	95	185	FBMML11063
75	3"1/2	24	6,8	130	250	FBMML11075
90	4"	25	8,2	150	380	FBMML11090
110	5"	28	10	170	630	FBMML11110

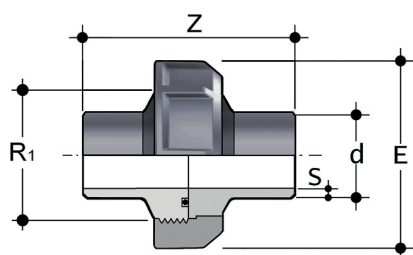

## BBM-C

Bocchettone codolo corto per saldatura di testa con guarnizione in EPDM o FKM

d	DN	E	S	Z	g	Codice *EPDM SDR 11 - S 5	Codice **FKM SDR 11 - S 5
20	15	46	1,9	110	80	BBMC11020E	BBMC11020F
25	20	56	2,3	110	75	BBMC11025E	BBMC11025F
32	25	66	2,9	110	120	BBMC11032E	BBMC11032F
40	32	79	3,7	110	175	BBMC11040E	BBMC11040F
50	40	87	4,6	110	240	BBMC11050E	BBMC11050F
63	50	107	5,8	110	440	BBMC11063E	BBMC11063F

\* O-ring in EPDM  
\*\* O-ring in FKM

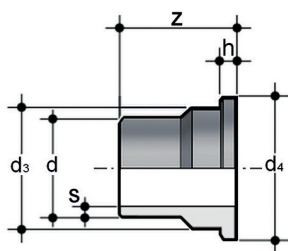

## Q/BBM-C

CONNETTORI IN PP-H, codolo corto, per saldatura di testa

d	d <sub>3</sub>	d <sub>4</sub>	h	s	Z	g	Codice SDR 11 - S 5
20	27,4	30	5	1,9	55	20	QBBMC11020
25	35,9	38,7	6	2,3	55	22	QBBMC11025
32	41,4	44,6	6	2,9	55	36	QBBMC11032
40	52,8	56,4	7	3,7	55	54	QBBMC11040
50	58,8	62,5	7	4,6	55	76	QBBMC11050
63	73,8	78,3	8	5,8	55	118	QBBMC11063
75	82,5	96,5	9	6,8	55	250	QBBMC11075
90	97,5	109,5	10	8,2	90	310	QBBMC11090
110	117,5	134,5	11	10	90	610	QBBMC11110

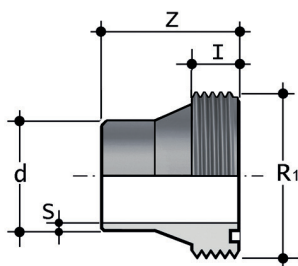

## F/BBM-C

Pezzo fisso codolo corto per saldatura di testa per bocchettone BBM-C

d	R	I	s	Z	g	Codice SDR 11 - S 5
20	1"	13	1,9	55	20	FBBMC11020
25	1"1/4	13	2,3	55	27	FBBMC11025
32	1"1/2	14	2,9	55	40	FBBMC11032
40	2"	16	3,7	55	60	FBBMC11040
50	2"1/4	18	4,6	55	86	FBBMC11050
63	2"3/4	20	5,8	55	147	FBBMC11063
75	3"1/2	24	6,8	55	200	FBBMC11075
90	4"	25	8,2	90	310	FBBMC11090
110	5"	28	10	90	600	FBBMC11110

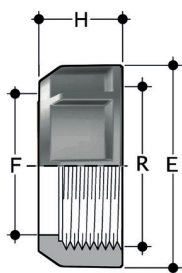

## EFGM

Ghiera con filettatura cilindrica per bocchettoni BIGM, BIFGM, BIFOM, BIROM, BIFXM, BIRXM

R	d BIGM	PN	E	F	H	g	Codice
1"	20	10	47	28	22	19	EFGM100
1"1/4	25	10	58	36	25	29	EFGM114
1"1/2	32	10	65	42	27	40	EFGM112
2"	40	10	78	53	30	57	EFGM200
2"1/4	50	10	85	59	33	74	EFGM214
2"3/4	63	10	103	74	38	119	EFGM234

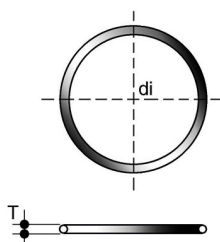

## O-RING

Guarnizione per bocchettoni tipo BIV, BIFV, BFV, BLV, BIRV, BIFOV, BIROV, BIFXV, BIRXV

d bocchettone	C	di	T	Codice EPDM	Codice FKM
16	3062	15,54	2,62	OR3062E	OR3062F
20	4081	20,22	3,53	OR4081E	OR4081F
25	4112	28,17	3,53	OR4112E	OR4112F
32	4131	32,93	3,53	OR4131E	OR4131F
40	6162	40,65	5,34	OR6162E	OR6162F
50	6187	47	5,34	OR6187E	OR6187F
63	6237	59,69	5,34	OR6237E	OR6237F
75	6300	75,57	5,34	OR6300E	OR6300F
90	6362	91,45	5,34	OR6362E	OR6362F
110	6450	113,67	5,34	OR6450E	OR6450F

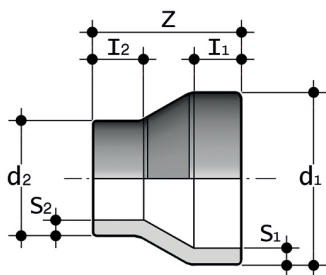

## RBM

Riduzione concentrica codolo corto per saldatura di testa SDR 17,6 - S 8,3

d <sub>1</sub>	d <sub>2</sub>	l <sub>1</sub>	l <sub>2</sub>	Z	S <sub>1</sub>	S <sub>2</sub>	g	Codice SDR 17,6 - S 8,3
50	32	12	12	55	2.9	2	17	RBM17050032
50	40	12	12	55	2.9	2,3	20	RBM17050040
63	32	16	12	65	3.6	2	32	RBM17063032
63	40	16	12	65	3.6	2,3	36	RBM17063040
63	50	16	12	65	3.6	2.9	38	RBM17063050
75	32	19	12	80	4.3	2	55	RBM17075032
75	40	19	12	71	4.3	2,3	50	RBM17075040
75	50	19	12	71	4.3	2.9	54	RBM17075050
75	63	19	16	71	4.3	3.6	60	RBM17075063
90	50	22	12	80	5.1	2.9	86	RBM17090050
90	63	22	16	80	5.1	3.6	82	RBM17090063
90	75	22	19	80	5.1	4.3	102	RBM17090075
110	50	28	12	105	6.3	2.9	100	RBM17110050
110	63	28	16	97	6.3	3.6	100	RBM17110063
110	75	28	19	97	6.3	4.3	90	RBM17110075
110	90	28	22	97	6.3	5.1	160	RBM17110090
125	63	35	20	97	7.1	3.6	195	RBM17125063S
125	75	32	19	108	7.1	4.3	130	RBM17125075
125	90	32	22	108	7.1	5.1	130	RBM17125090
125	110	32	28	108	7.1	6.3	150	RBM17125110
140	75	35	19	123	8	4.3	160	RBM17140075
140	90	35	22	115	8	5.1	170	RBM17140090
140	110	35	28	115	8	6.3	140	RBM17140110
140	125	35	32	115	8	7.1	150	RBM17140125
160	90	40	22	135	9.1	5.1	400	RBM17160090
160	110	40	28	124	9.1	6.3	350	RBM17160110
160	125	40	32	124	9.1	7.1	400	RBM17160125
160	140	40	35	124	9.1	8	250	RBM17160140
180	90	53	42	145	10.2	5.1	600	RBM17180090S
180	110	45	28	157	10.2	6.3	630	RBM17180110
180	125	45	32	136	10.2	7.1	370	RBM17180125
180	140	45	35	136	10.2	8	510	RBM17180140
180	160	45	40	136	10.2	9.1	500	RBM17180160
200	140	50	35	154	11.4	8	750	RBM17200140
200	160	50	40	151	11.4	9.1	670	RBM17200160
200	180	50	45	151	11.4	10,2	920	RBM17200180
225	140	52	49	150	12.7	8	1060	RBM17225140S
225	160	55	40	171	12.8	9.1	700	RBM17225160
225	180	55	45	171	12.8	10,2	580	RBM17225180
225	200	55	50	171	12.8	11.4	700	RBM17225200
250	160	60	40	194	14.2	9.1	880	RBM17250160
250	180	60	45	182	14.2	10,2	660	RBM17250180
250	200	60	50	182	14.2	11.4	730	RBM17250200
250	225	60	55	182	14.2	12.8	680	RBM17250225
280	200	85	70	200	15.9	11.4	2400	RBM17280200
280	225	70	55	200	15.9	12.8	2370	RBM17280225S
280	250	85	92	200	15.9	14.2	2540	RBM17280250S



d <sub>1</sub>	d <sub>2</sub>	l <sub>1</sub>	l <sub>2</sub>	Z	S <sub>1</sub>	S <sub>2</sub>	g	Codice SDR 17,6 - S 8,3
315	200	95	85	230	17.9	11.4	3220	RBM17315200S
315	225	84	60	238	17.9	12.8	3320	RBM17315225
315	250	95	95	230	17.9	14.2	3500	RBM17315250
315	280	80	70	222	17.9	15.9	3510	RBM17315280S
355	200	57	40	160	20,1	11.4	3220	RBM17355200
355	225	57	40	140	20,1	12,7	3200	RBM17355225S
355	250	54	40	130	20,1	14,2	2300	RBM17355250
355	280	53	40	120	20.1	15.9	2740	RBM17355280S
355	315	53	40	110	20.1	17.9	2500	RBM17355315S
400	225	64	40	160	22.7	12.7	4600	RBM17400225S
400	250	61	40	150	22.7	14.2	4400	RBM17400250S
400	280	60	40	140	22.7	15.9	4200	RBM17400280S
400	315	50	40	120	22.7	17.9	3360	RBM17400315S
400	355	51	40	110	22.7	20.1	3160	RBM17400355S
450	280	65	40	160	25.5	15.9	4360	RBM17450280S
450	315	55	40	140	25.5	17.9	4900	RBM17450315S
450	355	57	40	130	25.5	20.1	4900	RBM17450355S
450	400	60	40	120	25.5	22.7	4600	RBM17450400S
500	315	71	40	170	28.4	17.9	8440	RBM17500315S
500	355	62	40	150	28.4	20.1	7720	RBM17500355S
500	400	65	40	140	28.4	22.7	7360	RBM17500400S
500	450	60	40	120	28.4	25.5	5260	RBM17500450S
560	400	68	40	160	31.7	22.7	9400	RBM17560400S
560	450	62	40	140	31.7	25.5	8960	RBM17560450S
560	500	67	40	130	31.7	28.4	7270	RBM17560500S
630	400	78	40	190	35.7	22.7	14620	RBM17630400S
630	450	72	40	170	35.7	25.5	13100	RBM17630450S
630	500	67	40	150	35.7	28.4	11400	RBM17630500S
630	560	64	40	130	35.7	31.7	10200	RBM17630560S
710	500	84	40	190	40.2	25.5	19000	RBM17710500S
710	560	81	40	170	40.2	28.4	17400	RBM17710560S
710	630	71	40	140	40.2	35.7	13700	RBM17710630S
800	560	85	40	200	45.3	31.7	19700	RBM17800560S
800	630	85	40	180	45.3	35.7	23400	RBM17800630S
800	710	78	40	150	45.3	40.2	18900	RBM17800710S

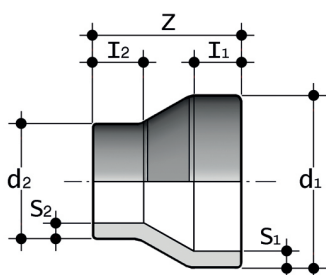

## RBM

Riduzione concentrica codolo corto per saldatura di testa SDR 11 - S 5

d <sub>1</sub>	d <sub>2</sub>	l <sub>1</sub>	l <sub>2</sub>	Z	S <sub>1</sub>	S <sub>2</sub>	g	Codice SDR 11 - S 5
25	20	12	12	37	2,3	1,9	5	RBM11025020
32	20	12	12	43	2,9	1,9	8	RBM11032020
32	25	12	12	43	2,9	2,3	10	RBM11032025
40	20	12	12	50	3,7	1,9	13	RBM11040020
40	25	12	12	50	3,7	2,3	15	RBM11040025
40	32	12	12	50	3,7	3	18	RBM11040032
50	25	12	12	55	4,6	2,3	23	RBM11050025
50	32	12	12	55	4,6	3	25	RBM11050032
50	40	12	12	55	4,6	3,7	29	RBM11050040
63	32	16	12	65	5,8	3	43	RBM11063032
63	40	16	12	65	5,8	3,7	50	RBM11063040
63	50	16	12	65	5,8	4,6	55	RBM11063050
75	32	19	12	80	6,8	3	70	RBM11075032
75	40	19	12	71	6,8	3,7	71	RBM11075040
75	50	19	12	71	6,8	4,6	79	RBM11075050
75	63	19	16	71	6,8	5,8	89	RBM11075063
90	50	22	12	80	8,2	4,6	125	RBM11090050
90	63	22	16	80	8,2	5,8	129	RBM11090063
90	75	22	19	80	8,2	6,9	155	RBM11090075
110	50	28	12	105	10	4,6	150	RBM11110050
110	63	28	16	97	10	5,8	200	RBM11110063
110	75	28	19	97	10	6,9	160	RBM11110075
110	90	28	22	97	10	8,2	140	RBM11110090
125	63	30	16	112	11,4	5,8	180	RBM11125063
125	75	32	19	108	11,4	6,9	200	RBM11125075
125	90	32	22	108	11,4	8,2	200	RBM11125090
125	110	32	28	108	11,4	10	220	RBM11125110
140	75	35	19	123	12,7	6,9	240	RBM11140075
140	90	35	22	115	12,7	8,2	260	RBM11140090
140	110	35	28	115	12,7	10	210	RBM11140110
140	125	35	32	115	12,7	11,4	220	RBM11140125
160	90	48	34	141	14,6	8,2	695	RBM11160090S
160	110	40	28	124	14,6	10	430	RBM11160110
160	125	40	32	124	14,6	11,4	700	RBM11160125
160	140	40	35	124	14,6	12,8	370	RBM11160140
180	90	45	22	157	16,4	8,2	660	RBM11180090
180	110	45	28	157	16,4	10	900	RBM11180110
180	125	45	32	136	16,4	11,4	510	RBM11180125
180	140	45	35	136	16,4	12,8	610	RBM11180140
180	160	45	40	136	16,4	14,6	700	RBM11180160
200	140	50	35	154	18,2	12,8	730	RBM11200140
200	160	50	40	151	18,2	14,6	700	RBM11200160
200	180	50	45	151	18,2	16,4	1300	RBM11200180
225	140	61	48	157	20,5	12,7	1575	RBM11225140S
225	160	55	40	171	20,5	14,6	960	RBM11225160
225	180	55	45	171	20,5	16,4	1020	RBM11225180

d <sub>1</sub>	d <sub>2</sub>	l <sub>1</sub>	l <sub>2</sub>	Z	S <sub>1</sub>	S <sub>2</sub>	g	Codice SDR 11 - S 5
225	200	55	50	171	20,5	18,2	1200	RBM11225200
250	160	60	40	194	22,7	14,6	1480	RBM11250160
250	180	60	45	182	22,7	16,4	1200	RBM11250180
250	200	60	50	182	22,7	18,2	1110	RBM11250200
250	225	60	55	182	22,7	20,5	1040	RBM11250225
280	200	75	54	214	25,4	18,2	3450	RBM11280200S
280	225	72	57	203	25,4	20,5	3425	RBM11280225S
280	250	72	62	202	25,4	22,7	1980	RBM11280250
315	200	80	50	230	28,6	18,2	4520	RBM11315200
315	225	84	60	237	28,6	20,5	5110	RBM11315225S
315	250	86	63	231	28,6	22,7	5105	RBM11315250S
315	280	80	70	222	28,6	25,4	5195	RBM11315280S
355	200	57	40	160	32,3	18,2	4400	RBM11355200
355	225	57	40	140	32,3	20,5	4390	RBM11355225
355	250	54	40	140	32,2	22,7	3940	RBM11355250S
355	280	53	40	120	32,2	25,4	3720	RBM11355280S
355	315	53	40	110	32,2	28,6	3540	RBM11355315S
400	225	64	40	160	36,3	20,5	6100	RBM11400225S
400	250	61	40	150	36,3	22,7	5800	RBM11400250S
400	280	60	40	140	36,3	25,4	5500	RBM11400280S
400	315	50	40	120	36,3	28,6	4660	RBM11400315S
400	355	51	40	110	36,3	32,2	4480	RBM11400355S
450	280	65	40	160	40,9	25,4	9000	RBM11450280S
450	315	55	40	140	40,9	28,6	6720	RBM11450315S
450	355	57	40	130	40,9	32,2	6580	RBM11450355S
450	400	60	40	120	40,9	36,3	6380	RBM11450400S
500	315	71	40	170	45,4	28,6	11000	RBM11500315S
500	355	62	40	150	45,4	32,2	9300	RBM11500355S
500	400	65	40	140	45,4	36,3	9100	RBM11500400S
500	450	60	40	120	45,4	40,9	8300	RBM11500450S
560	400	68	40	160	50,8	36,3	12800	RBM11560400S
560	450	62	40	140	50,8	40,9	12900	RBM11560450S
560	500	67	40	130	50,8	45,4	11400	RBM11560500S

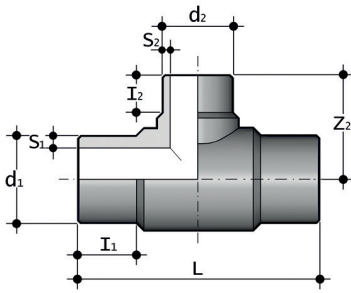

## TRBM

Ti a 90° ridotto codolo corto per saldatura di testa SDR 17,6 - S 8,3

d <sub>1</sub>	d <sub>2</sub>	i <sub>1</sub>	i <sub>2</sub>	L	s <sub>1</sub>	s <sub>2</sub>	Z <sub>2</sub>	g	Codice SDR 17,6 - S 8,3
*63	50	63	56	220	3.8	3	103	210	TRBM17063050
*75	50	70	55	253	4.5	3	113	410	TRBM17075050
*75	63	70	63	260	4.5	3.8	117	420	TRBM17075063
*90	63	79	63	275	5.4	3.8	137	570	TRBM17090063
*90	75	74	70	278	5.4	4.5	138	570	TRBM17090075
*110	63	85	66	315	6.6	3.8	159	960	TRBM17110063
*110	75	82	70	315	6.6	4.5	157	850	TRBM17110075
*110	90	82	79	315	6.6	5.4	155	900	TRBM17110090
125	63	70	31	271	7.4	3.8	112	1030	TRBM17125063
*125	110	87	82	340	7.4	6.6	170	1240	TRBM17125110
140	63	83	32	291	8.0	3.6	120	1290	TRBM17140063S
140	75	81	35	291	8.0	4.3	120	1370	TRBM17140075S
140	90	81	41	291	8.0	5.1	130	1380	TRBM17140090S
140	110	50	44	291	8.0	6.3	140	1600	TRBM17140110S
*160	63	98	64	347	9.5	3.8	175	1850	TRBM17160063
*160	75	98	75	348	9.5	4.5	179	1910	TRBM17160075
*160	90	100	81	349	9.5	5.4	182	1940	TRBM17160090
*160	110	98	85	400	9.5	6.6	202	2360	TRBM17160110
160	125	58	47	315	9.1	7.1	150	2060	TRBM17160125S
180	63	125	30	348	10.2	3.6	140	2160	TRBM17180063S
180	75	112	30	348	10.2	4.3	160	2230	TRBM17180075S
*180	90	134	97	420	10.7	5.4	200	2800	TRBM17180090
180	110	92	50	348	10.2	6.3	150	2325	TRBM17180110S
180	125	92	50	358	10.7	7.4	156	2240	TRBM17180125
*180	160	105	91	412	10.7	9.5	204	3070	TRBM17180160
*200	63	134	80	550	11.9	3.8	225	4960	TRBM17200063
*200	90	134	95	550	11.9	5.4	227	4900	TRBM17200090
*200	110	134	103	560	11.9	6.6	245	5110	TRBM17200110
*200	125	134	110	550	11.9	7.4	240	5060	TRBM17200125
*200	160	134	114	550	11.9	9.5	265	6150	TRBM17200160
*225	75	120	75	451	13.4	4.5	226	4630	TRBM17225075
*225	90	120	79	450	13.4	5.4	224	4820	TRBM17225090
*225	110	120	86	449	13.4	6.6	226	4960	TRBM17225110
225	125	-	-	445	13.4	7.4	180	4830	TRBM17225125S
*225	160	120	98	498	13.4	9.5	250	6130	TRBM17225160
*225	180	134	134	558	13.4	10.7	280	7100	TRBM17225180
250	110	135	33	443	14.2	6.3	195	5830	TRBM17250110S
250	160	110	58	440	14.2	9.1	213	6020	TRBM17250160S

\* codolo lungo

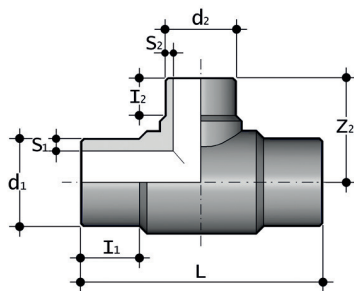

## TRBM

Ti a 90° ridotto codolo corto per saldatura di testa SDR 11 - S 5

$d_1$	$d_2$	$i_1$	$i_2$	L	$s_1$	$s_2$	$Z_2$	g	Codice SDR 11 - S 5
*63	50	63	56	215	5.8	4.6	103	300	TRBM11063050S
*75	32	70	46	256	6.8	2.9	103	500	TRBM11075032
*75	50	70	56	253	6.8	4.6	113	540	TRBM11075050S
*75	63	70	63	255	6.8	5.8	117	560	TRBM11075063S
90	32	53	23	203	8.2	2.9	85	560	TRBM11090032
90	50	53	28	213	8.2	4.6	100	580	TRBM11090050
*90	63	82	66	282	8.2	5.8	127	790	TRBM11090063S
*90	75	73	68	280	8.2	6.8	138	800	TRBM11090075S
110	32	66	22	234	10.0	2.9	91	940	TRBM11110032
110	50	66	27	240	10.0	4.6	101	950	TRBM11110050S
*110	63	88	68	328	10.0	5.8	149	1345	TRBM11110063S
*110	75	86	70	320	10.0	6.8	151	1250	TRBM11110075S
*110	90	86	79	320	10.0	8.2	158	1440	TRBM11110090S
125	63	54	25	254	10.0	5.8	107	1360	TRBM11125063S
*125	90	-	-	340	11.4	8.2	170	1660	TRBM11125090S
*125	110	90	83	341	11.4	10	170	1860	TRBM11125110S
140	63	83	32	291	12.7	5.8	120	1740	TRBM11140063S
140	75	81	35	291	12.7	6.8	130	1840	TRBM11140075S
140	90	81	41	291	12.7	8.2	130	1960	TRBM11140090S
140	110	50	44	291	12.7	10	140	2200	TRBM11140110
*160	63	100	67	347	14.6	5.8	175	2640	TRBM11160063
*160	75	98	74	343	14.6	6.8	180	2560	TRBM11160075S
*160	90	104	83	412	14.6	8.2	190	3685	TRBM11160090S
*160	110	104	89	414	14.6	10	200	3685	TRBM11160110S
160	125	58	47	315	14.6	11.4	150	2750	TRBM11160125S
180	63	125	30	348	16.4	5.8	140	2980	TRBM11180063S
180	75	112	30	348	16.4	6.8	160	3060	TRBM11180075S
*180	90	-	-	427	16.4	8.2	200	4360	TRBM11180090S
*180	110	-	-	464	16.4	10	225	4640	TRBM11180110S
180	125	-	-	366	16.4	11.4	166	3220	TRBM11180125S
*180	160	105	94	411	16.4	14.6	205	4390	TRBM11180160
*200	63	122	63	500	18.2	5.8	190	5700	TRBM11200063S
*200	90	122	79	498	18.2	5.1	207	6550	TRBM11200090S
*200	110	122	82	500	18.2	6.3	215	7040	TRBM11200110S
*200	125	115	43	388	18.2	11.4	165	6920	TRBM11200125
*200	160	122	98	500	18.2	9.1	234	8300	TRBM11200160S
*225	75	120	70	555	20.5	6.8	227	6400	TRBM11225075S
*225	90	129	82	556	20.5	8.2	228	9380	TRBM11225090S
*225	110	130	86	556	20.5	10	238	6600	TRBM11225110S
225	125	135	40	456	20.5	11.4	178	6120	TRBM11225125S
*225	160	101	98	498	20.5	14.6	247	8280	TRBM11225160
*225	180	135	135	558	20.5	16.4	280	9540	TRBM11225180
250	110	135	38	450	22.7	10	197	7700	TRBM11250110
250	160	110	58	458	22.7	14.6	213	8040	TRBM11250160
*315	110	150	82	695	28.6	10	277	15280	TRBM11315110S
*315	160	150	102	695	28.6	14.6	290	16600	TRBM11315160S
*315	225	-	-	650	28.6	20.5	335	24820	TRBM11315225S
*315	250	150	130	695	28.6	22.7	325	21000	TRBM11315250S

\* codolo lungo

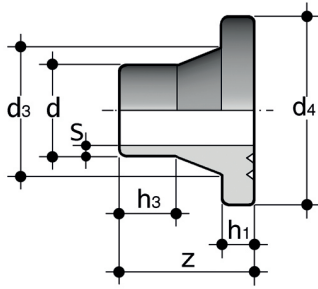

## QBM

Collare d'appoggio codolo corto per saldatura di testa per flange libere ISO/DIN ODB  
SDR 17,6 - S 8,3

d	d <sub>3</sub>	d <sub>4</sub>	h <sub>1</sub>	h <sub>3</sub>	S	Z	g	Codice SDR 17,6 - S 8,3
40	50	78	11	24	2,3	50	60	QBM17040
50	61	88	12	23	2,9	50	77	QBM17050
63	75	102	14	18	3,6	50	115	QBM17063
75	89	122	16	35	4,3	50	180	QBM17075
90	105	138	17	43	5,1	80	280	QBM17090
110	125	158	18	37	6,3	80	365	QBM17110
125	132	158	18	42	7,1	80	390	QBM17125
140	155	188	18	34	8	80	530	QBM17140
160	175	212	18	34	9,1	80	660	QBM17160
180	182	212	20	30	10,2	80	610	QBM17180
200	232	268	24	36	11,4	100	1440	QBM17200
225	235	268	24	46	12,8	100	1290	QBM17225
250	285	320	25	35	14,2	100	2035	QBM17250
280	291	320	25	45	15,9	100	1825	QBM17280
315	335	370	25	35	17,9	100	2525	QBM17315
355	373	430	30	99	20,1	184	5460	QBM17355S
400	427	482	33	98	22,7	195	7120	QBM17400S
450	514	585	46	60	25,5	142	9935	QBM17450S
500	530	585	46	60	28,4	138	9195	QBM17500S
560	615	685	50	60	31,7	139	13150	QBM17560S
630	642	685	50	60	35,7	140	11685	QBM17630S
800	840	905	54	60	45,3	150	19000	QBM17800S
900	944	1005	55	50	51,0	155	26400	QBM17900S
1000	1047	1110	60	50	56,7	180	39100	QBM171000S

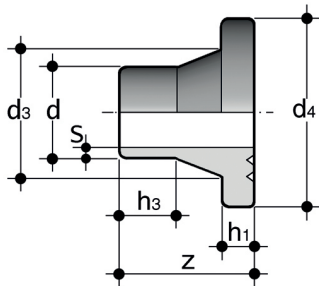

## QBM

Collare d'appoggio codolo corto per saldatura di testa per flange libere ISO/DIN ODB  
SDR 11 - S 5

d	d <sub>3</sub>	d <sub>4</sub>	h <sub>1</sub>	h <sub>3</sub>	S	Z	g	Codice SDR 11 - S 5
20	27	45	7	30	1.9	50	15	QBM11020
25	33	58	9	26	2.3	50	30	QBM11025
32	40	68	10	25	2.9	50	45	QBM11032
40	50	78	11	24	3.7	50	66	QBM11040
50	61	88	12	21	4.6	50	87	QBM11050
63	75	102	14	16	5.8	50	129	QBM11063
75	89	122	16	14	6.8	50	200	QBM11075
90	105	138	17	33	8.2	80	322	QBM11090
110	125	158	18	27	10	80	430	QBM11110
125	132	158	25	35	11.4	80	490	QBM11125
140	155	188	25	27	12.7	80	715	QBM11140
160	175	212	25	27	14.6	80	915	QBM11160
180	182	212	30	50	16.4	80	890	QBM11180
200	232	268	32	28	18.2	100	1900	QBM11200
225	235	268	32	38	20.5	100	1780	QBM11225
250	285	320	35	25	22.7	100	2865	QBM11250
280	291	320	35	35	25.4	100	2600	QBM11280
315	335	370	35	25	28.6	100	3500	QBM11315
355	373	430	40	90	32.2	180	7730	QBM11355S
400	427	482	46	95	36.3	195	10485	QBM11400S
450	514	585	60	60	40.9	139	13350	QBM11450S
500	530	585	60	60	45.4	138	12730	QBM11500S
560	615	685	60	60	50.8	140	16100	QBM11560S
630	642	685	60	60	57.2	140	17900	QBM11630S

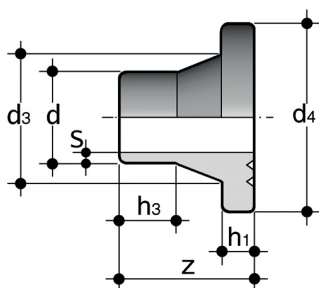

## QBAM

Collare d'appoggio codolo corto per saldatura di testa, per flange libere ANSI B16.5  
cl.150 OAB\* SDR 17,6 - S 8,3

d	Dimensione OAB	d <sub>3</sub>	d <sub>4</sub>	h <sub>1</sub>	h <sub>3</sub>	S	Z	g	Codice SDR 17,6 - S 8,3
40	1" 1/4	50	72	11	24	2,3	50	60	QBAM17114
50	1" 1/2	61	84.5	12	23	2.9	50	77	QBAM17112
90	3"	105	132	17	43	5,1	80	280	QBAM17300

\* per altre dimensioni usare QBM

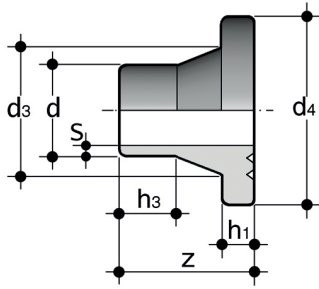

## QBAM

Collare d'appoggio codolo corto per saldatura di testa, per flange libere ANSI B16.5 cl.150 OAB\* SDR 11 - S 5

d	Dimensione OAB	$d_3$	$d_4$	$h_1$	$h_3$	s	Z	g	Codice SDR 11 - S 5
25	3/4"	33	54	9	26	2,3	50	30	QBAM11034
32	1"	40	63.5	10	25	2,9	50	45	QBAM11100
40	1" 1/4	50	72	11	24	3,7	50	66	QBAM11114
50	1" 1/2	61	84.5	12	21	4,6	50	87	QBAM11112
90	3"	105	132	17	33	8,2	80	322	QBAM11300

\* per altre dimensioni usare QBM



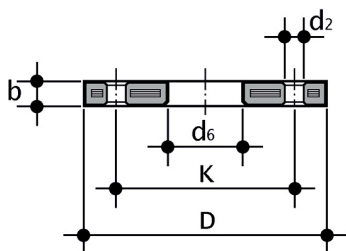

## ODB

Flangia libera in acciaio rivestito in PP/FRP secondo EN/ISO/DIN per collari d'appoggio QBM. Foratura PN 10/16 fino a d180, PN 10 da d200 a d400

d	DN	*PMA (bar)	b	d <sub>2</sub>	d <sub>6</sub>	D	K	M	n	** (Nm)	g	Codice
20	15	16	12	14	28	95	65	M12	4	15	232	ODB020
25	20	16	14	14	34	105	75	M12	4	15	288	ODB025
32	25	16	14	14	42	115	85	M12	4	15	544	ODB032
40	32	16	16	18	51	140	100	M16	4	20	836	ODB040
50	40	16	16	18	62	150	110	M16	4	30	902	ODB050
63	50	16	19	18	78	165	125	M16	4	35	1074	ODB063
75	65	16	19	18	92	185	145	M16	4	40	1368	ODB075
90	80	16	21	18	108	200	160	M16	8	40	1516	ODB090
110	100	16	22	18	128	220	180	M16	8	40	1960	ODB110
125	100	16	22	18	135	220	180	M16	8	40	1938	ODB125
140	125	16	26	18	158	250	210	M16	8	50	2866	ODB140
160	150	16	27	22	178	285	240	M20	8	60	3576	ODB160
180	150	16	27	22	188	285	240	M20	8	60	3298	ODB180
200	200	16	28	22	235	340	295	M20	8	70	5318	ODB200
225	200	16	28	22	238	340	295	M20	8	70	5500	ODB225
250	250	16	31	22	288	406	350	M20	12	80	6962	ODB250
280	250	16	31	22	294	406	350	M20	12	80	7092	ODB280
315	300	16	34	22	338	460	400	M20	12	100	9428	ODB315
355	350	16	39	23	377	520	460	M20	16	120	19285	ODB355
400	400	16	43	27	430	580	515	M24	16	140	21370	ODB400
450	500	10	45	26	517	678	620	M24	20	150	34520	ODB450
500	500	10	45	26	533	678	620	M24	20	150	34000	ODB500
560	600	10	50	30	618	790	725	M27	20	170	49000	ODB560
630	600	10	50	30	645	790	725	M27	20	170	40000	ODB630

\*PMA: pressione di esercizio massima ammissibile  
 \*\*momento di serraggio nominale

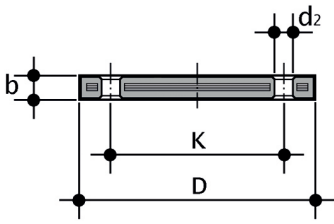

## ODBC

Flangia cieca in acciaio rivestito in PP/FRP secondo EN/ISO/DIN.  
Foratura PN 10/16 fino a d160/180, PN 10 da d200/225 a d400

d	DN	*PMA (bar)	b	d <sub>2</sub>	D	k	M	n	** (Nm)	g	Codice
20	15	10	16	14	95	65	M12	4	15	290	ODBC020S
25	20	10	12	18	105	75	M12	4	15	380	ODBC025S
32	25	10	18	14	115	85	M12	4	15	600	ODBC032S
40	32	10	17	18	140	100	M16	4	25	830	ODBC040S
50	40	10	18	18	150	110	M16	4	35	1105	ODBC050S
63	50	10	18	18	165	125	M16	4	35	1308	ODBC063S
75	65	10	18	18	185	145	M16	4	40	1580	ODBC075S
90	80	10	20	18	200	160	M16	8	40	2244	ODBC090S
110	100	10	20	18	220	180	M16	8	45	2829	ODBC110S
125	100	10	20	18	220	180	M16	8	45	2873	ODBC125S
140	125	10	24	18	250	210	M16	8	50	3920	ODBC140S
160	150	10	22	22	285	240	M20	8	60	7181	ODBC160S
180	150	10	24	22	285	240	M20	8	60	7130	ODBC180S
200	200	10	24	22	340	295	M20	8	70	10580	ODBC200S
225	200	10	24	22	340	295	M20	8	70	10664	ODBC225S
250	250	10	30	22	395	350	M20	12	100	14040	ODBC250S
280	250	10	30	22	395	350	M20	12	100	14040	ODBC280S
315	300	16	34	22	445	400	M20	12	110	26480	ODBC315S
355	350	10	39	22	505	460	M20	16	160	39000	ODBC355S
400	400	10	46	25	574	515	M24	16	170	50400	ODBC400S

\*PMA: pressione di esercizio massima ammissibile  
\*\*momento di serraggio nominale

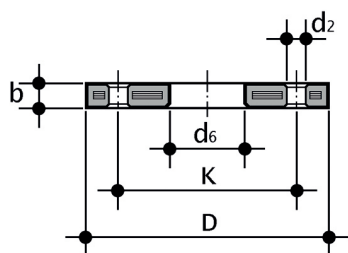

## OAB

Flangia libera in acciaio rivestito in PP/FRP secondo ANSI B16.5 cl.150 per collari QBM e QBAM

Pollici	DN	*PMA (bar)	b	d2 mm	d2 inch	d <sub>6</sub>	D	kmm	k inch	n	** (Nm)	g	Codice
1/2"	15	16	12	16	5/8"	28	95	60.45	2" 3/8	4	15	200	OAB012
3/4"	20	16	12	16	5/8"	34	102	69.85	2" 3/4	4	15	240	OAB034
1"	25	16	16	16	5/8"	42	114	79.25	3" 1/8	4	15	490	OAB100
1" 1/4	32	16	16	16	5/8"	51	130	88.9	3" 1/2	4	25	670	OAB114
1" 1/2	40	16	18	16	5/8"	62	133	98.55	3" 7/8	4	35	640	OAB112
2"	50	16	18	20	3/4"	78	162	120.65	4" 3/4	4	35	1000	OAB200
2" 1/2	65	16	18	20	3/4"	92	184	139.7	5" 1/2	4	40	1310	OAB212
3"	80	16	18	20	3/4"	111	194	152.4	6"	4	40	1250	OAB300
4"	100	16	18	20	3/4"	133	229	190.5	7" 1/2	8	40	1660	OAB400
6"	150	16	24	22	7/8"	178	283	241.3	9" 1/2	8	60	3750	OAB600
8"	200	10	24	22	7/8"	236	345	298.45	11" 3/4	8	70	5140	OAB800
10"	250	10	27	25	1"	288	412	361.95	14" 1/4	12	100	8080	OAB810
12"	315	10	32	25	1"	338	487	431.8	17"	12	110	15380	OAB812
14"	355	10	42	28,5	1" 1/8	376	533	476.2	17" 3/4	12	110	24940	OAB814
16"	400	10	44	28,5	1" 1/8	430	596	539.7	18" 13/32	16	110	34770	OAB816

\*PMA: pressione di esercizio massima ammissibile  
 \*\*momento di serraggio nominale

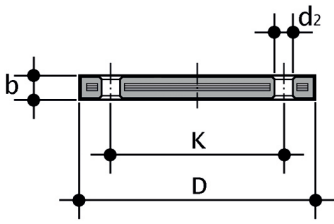

## OABC

Flangia cieca in acciaio rivestito in PP/FRP secondo ANSI B16.5 cl.150

d (pollici)	DN	*PMA (bar)	B	D	d2 mm	d2inch	Kmm	Kinch	** (Nm)	n	g	Codice
1/2"	15	16	12	95	16	5/8"	60,45	2" 3/8	15	4	200	OABC012
3/4"	20	16	12	102	16	5/8"	69,85	2" 3/4	15	4	240	OABC034
1"	25	16	16	114	16	5/8"	79,25	3" 1/8	15	4	370	OABC100
1" 1/4	32	16	16	130	16	5/8"	88,90	3" 1/2	25	4	530	OABC114
1" 1/2	40	16	18	133	16	5/8"	98,55	3" 7/8	35	4	560	OABC112
2"	50	16	18	162	20	3/4"	120,65	4" 3/4	35	4	810	OABC200
2" 1/2	65	16	18	184	20	3/4"	139,70	5" 1/2	40	4	1070	OABC212
3"	80	16	18	194	20	3/4"	152,40	6"	40	4	1030	OABC300
4"	100	16	18	229	20	3/4"	190,50	7" 1/2	40	8	1570	OABC400
6"	150	16	24	283	22	7/8"	241,3	9" 1/2	60	8	2400	OABC600
8"	200	16	24	345	22	7/8"	298,45	11" 3/4	70	8	3500	OABC800
10"	250	16	27	412	25	1"	361,95	14" 1/4	100	12	6200	OABC810
12"	300	16	32	487	25	1"	431,8	17"	110	12	13040	OABC812

\* PMA: pressione di esercizio massima ammissibile  
 \*\* momento di serraggio nominale

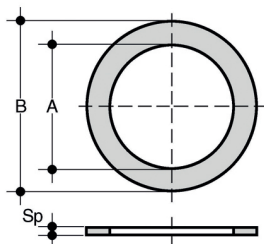

## QHV/X

Guarnizione piana in EPDM e FKM per flangiatura secondo DIN 2501, EN1092

d	DN	A	B	Sp	Codice EPDM	Codice FKM
20 - 1/2"	15	20	32	2	QHVX020E	QHVX020F
25 - 3/4"	20	24	38,5	2	QHVX025E	QHVX025F
32 - 1"	25	32	48	2	QHVX032E	QHVX032F
40 - 1" 1/4	32	40	59	2	QHVX040E	QHVX040F
50 - 1" 1/2	40	50	71	2	QHVX050E	QHVX050F
63 - 2"	50	63	88	2	QHVX063E	QHVX063F
75 - 2" 1/2	65	75	104	2	QHVX075E	QHVX075F
90 - 3"	80	90	123	2	QHVX090E	QHVX090F
110 - 4"	100	110	148	3	QHVX110E	QHVX110F

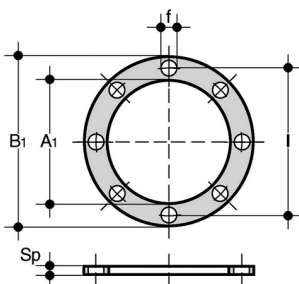

## QHV/Y

Guarnizione piana in EPDM per flangiatura secondo DIN 2501, EN 1092, autocentrante per foratura PN 10/16

d	DN	A <sub>1</sub>	B <sub>1</sub>	F	I	U	Sp	Codice
20 - 1/2"	15	17	95	14	65	4	2	QHVY020E
25 - 3/4"	20	22	107	14	76,3	4	2	QHVY025E
32 - 1"	25	28	117	14	86,5	4	2	QHVY032E
40 - 1" 1/4	32	36	142,5	18	101	4	2	QHVY040E
50 - 1" 1/2	40	45	153,3	18	111	4	2	QHVY050E
63 - 2"	50	57	168	18	125,5	4	2	QHVY063E
75 - 2" 1/2	65	71	187,5	18	145,5	4	3	QHVY075E
90 - 3"	80	84	203	18	160	8	3	QHVY090E
110 - 4"	100	102	223	18	181	8	3	QHVY110E