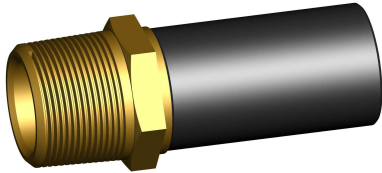
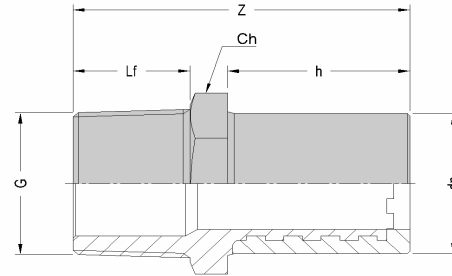

PRODUCT DETAILS

DIMENSIONS AND WEIGHT

ITEM	2177250020
dn [mm]	20
dn1 [mm]	
SDR	7,4
PN	25
MATERIAL	PE100
TRADEMARK	EURO
MANUFACTURING TYPE	INJECTION MOULDED
USE	WATER-GAS
QUANTITY PER BOX	30

dn	[mm]	20	
G	[mm]	1/2"	
Lf	[mm]	15	
h	[mm]	41	
Z	[mm]	61	
Ch	[mm]	22	

WEIGHT	[g]	60
--------	-----	----

Tolerance: +/- 5% excluding dn

NOTE:

MARKING AND LABEL on fitting
STANDARDS AND APPROVALS

EN 12201
EN 1555
ISO 15494

INFOS

- Weldable with electrofusion EURO SDR11 and SD7.4 fittings, in case of use with other brand fittings, please contact Eurostandard in advance
- Extension of the metallic overmoulded part on the whole length
- Suitable for gas and water pipelines
- Measure and respect the insertion depth inside the electrofusion fitting
- Weld only using electrofusion fittings
- Scraping of the PE end is compulsory
- During the screwing, lock the metallic hexagon to avoid any stress on the PE part

- Moulded in PE100-RC

All dimensions are in millimeters and are intended as nominal and standard sizes: weights are in grams.
EUROSTANDARD reserves the right to change geometries and dimensions of any product.

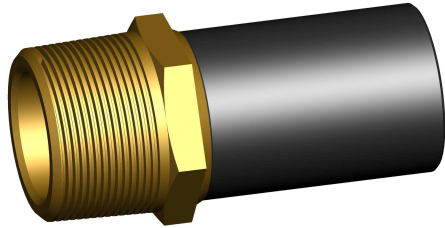
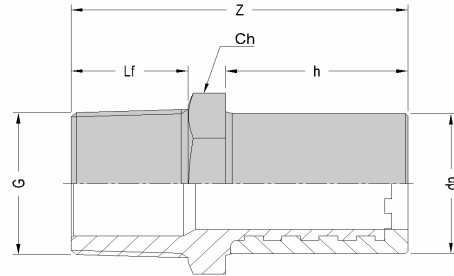
PRODUCT DETAILS

DIMENSIONS AND WEIGHT

ITEM	2177250025
dn [mm]	25
dn1 [mm]	
SDR	7,4
PN	25
MATERIAL	PE100
TRADEMARK	EURO
MANUFACTURING TYPE	INJECTION MOULDED
USE	WATER-GAS
QUANTITY PER BOX	30

dn	[mm]	25
G	[mm]	3/4"
Lf	[mm]	16
h	[mm]	41
Z	[mm]	62
Ch	[mm]	27

WEIGHT	[g]	90
--------	-----	----

Tolerance: +/- 5% excluding dn

MARKING AND LABEL on fitting
STANDARDS AND APPROVALS

EN 12201
 EN 1555
 ISO 15494

INFOS

- Weldable with electrofusion EURO SDR11 and SD7.4 fittings, in case of use with other brand fittings, please contact Eurostandard in advance
- Extension of the metallic overmoulded part on the whole length
- Suitable for gas and water pipelines
- Measure and respect the insertion depth inside the electrofusion fitting
- Weld only using electrofusion fittings
- Scraping of the PE end is compulsory
- During the screwing, lock the metallic hexagon to avoid any stress on the PE part

- Moulded in PE100-RC

All dimensions are in millimeters and are intended as nominal and standard sizes: weights are in grams.
 EUROSTANDARD reserves the right to change geometries and dimensions of any product.

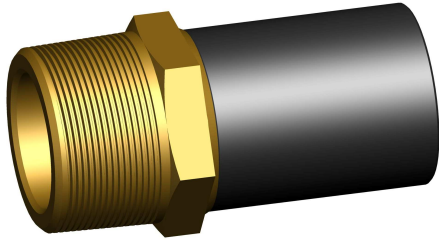
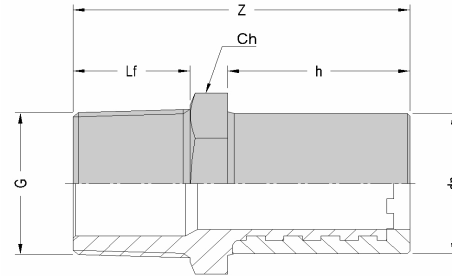
PRODUCT DETAILS

DIMENSIONS AND WEIGHT

ITEM	2177250032
dn [mm]	32
dn1 [mm]	
SDR	7,4
PN	25
MATERIAL	PE100
TRADEMARK	EURO
MANUFACTURING TYPE	INJECTION MOULDED
USE	WATER-GAS
QUANTITY PER BOX	30

dn	[mm]	32	
G	[mm]	1"	
Lf	[mm]	19	
h	[mm]	44	
Z	[mm]	70	
Ch	[mm]	34	

WEIGHT	[g]	150
--------	-----	-----

Tolerance: +/- 5% excluding dn

NOTE:

MARKING AND LABEL on fitting
STANDARDS AND APPROVALS

EN 12201
EN 1555
ISO 15494

INFOS

- Weldable with electrofusion EURO SDR11 and SD7.4 fittings, in case of use with other brand fittings, please contact Eurostandard in advance
- Extension of the metallic overmoulded part on the whole length
- Suitable for gas and water pipelines
- Measure and respect the insertion depth inside the electrofusion fitting
- Weld only using electrofusion fittings
- Scraping of the PE end is compulsory
- During the screwing, lock the metallic hexagon to avoid any stress on the PE part

- Moulded in PE100-RC

All dimensions are in millimeters and are intended as nominal and standard sizes: weights are in grams.
EUROSTANDARD reserves the right to change geometries and dimensions of any product.

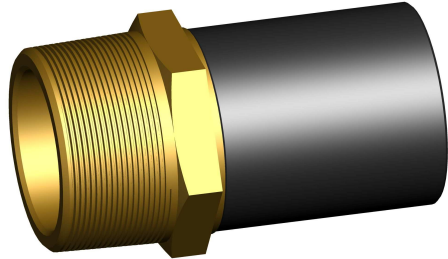
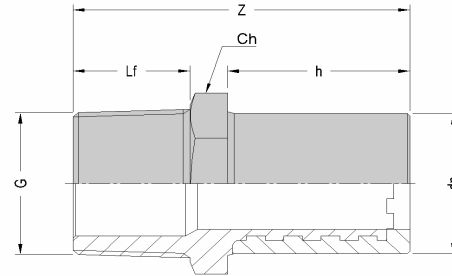
PRODUCT DETAILS

DIMENSIONS AND WEIGHT

ITEM	2177250040
dn [mm]	40
dn1 [mm]	
SDR	7,4
PN	25
MATERIAL	PE100
TRADEMARK	EURO
MANUFACTURING TYPE	INJECTION MOULDED
USE	WATER-GAS
QUANTITY PER BOX	12

dn	[mm]	40	
G	[mm]	1" 1/4	
Lf	[mm]	21	
h	[mm]	49	
Z	[mm]	78	
Ch	[mm]	42	

WEIGHT	[g]	250
--------	-----	-----

Tolerance: +/- 5% excluding dn

NOTE:

MARKING AND LABEL on fitting
STANDARDS AND APPROVALS

EN 12201
EN 1555
ISO 15494

INFOS

- Weldable with electrofusion EURO SDR11 and SD7.4 fittings, in case of use with other brand fittings, please contact Eurostandard in advance
- Extension of the metallic overmoulded part on the whole length
- Suitable for gas and water pipelines
- Measure and respect the insertion depth inside the electrofusion fitting
- Weld only using electrofusion fittings
- Scraping of the PE end is compulsory
- During the screwing, lock the metallic hexagon to avoid any stress on the PE part

- Moulded in PE100-RC

All dimensions are in millimeters and are intended as nominal and standard sizes: weights are in grams.
EUROSTANDARD reserves the right to change geometries and dimensions of any product.

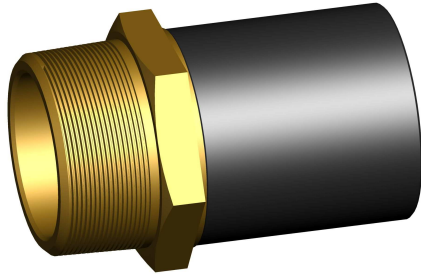
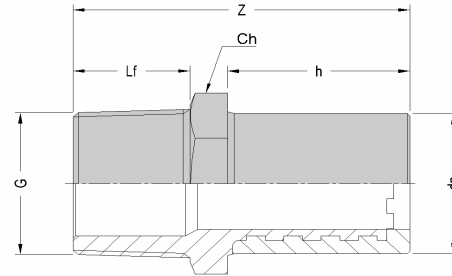
PRODUCT DETAILS

DIMENSIONS AND WEIGHT

ITEM	2177250050
dn [mm]	50
dn1 [mm]	
SDR	7,4
PN	25
MATERIAL	PE100
TRADEMARK	EURO
MANUFACTURING TYPE	INJECTION MOULDED
USE	WATER-GAS
QUANTITY PER BOX	16

dn	[mm]	50	
G	[mm]	1" 1/2	
Lf	[mm]	23	
h	[mm]	55	
Z	[mm]	88	
Ch	[mm]	52	

WEIGHT	[g]	377
--------	-----	-----

Tolerance: +/- 5% excluding dn

NOTE:

MARKING AND LABEL on fitting
STANDARDS AND APPROVALS

EN 12201
EN 1555
ISO 15494

INFOS

- Weldable with electrofusion EURO SDR11 and SD7.4 fittings, in case of use with other brand fittings, please contact Eurostandard in advance
- Extension of the metallic overmoulded part on the whole length
- Suitable for gas and water pipelines
- Measure and respect the insertion depth inside the electrofusion fitting
- Weld only using electrofusion fittings
- Scraping of the PE end is compulsory
- During the screwing, lock the metallic hexagon to avoid any stress on the PE part

- Moulded in PE100-RC

All dimensions are in millimeters and are intended as nominal and standard sizes: weights are in grams. EUROSTANDARD reserves the right to change geometries and dimensions of any product.

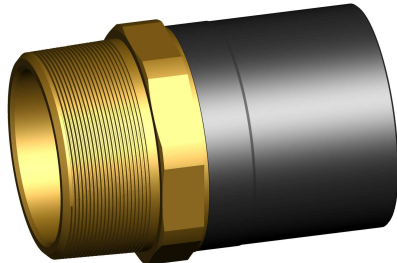
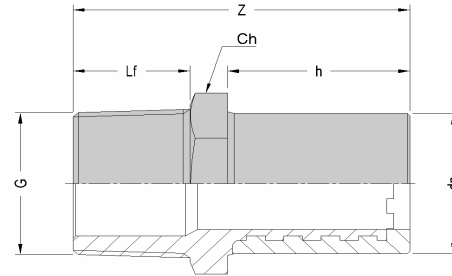
PRODUCT DETAILS

DIMENSIONS AND WEIGHT

ITEM	2177250063
dn [mm]	63
dn1 [mm]	
SDR	7,4
PN	25
MATERIAL	PE100
TRADEMARK	EURO
MANUFACTURING TYPE	INJECTION MOULDED
USE	WATER-GAS
QUANTITY PER BOX	20

dn	[mm]	63	
G	[mm]	2"	
Lf	[mm]	26	
h	[mm]	63	
Z	[mm]	100	
Ch	[mm]	65	

WEIGHT	[g]	650
--------	-----	-----

Tolerance: +/- 5% excluding dn

NOTE:

MARKING AND LABEL on fitting
STANDARDS AND APPROVALS

EN 12201
EN 1555
ISO 15494

INFOS

- Weldable with electrofusion EURO SDR11 and SD7.4 fittings, in case of use with other brand fittings, please contact Eurostandard in advance
- Extension of the metallic overmoulded part on the whole length
- Suitable for gas and water pipelines
- Measure and respect the insertion depth inside the electrofusion fitting
- Weld only using electrofusion fittings
- Scraping of the PE end is compulsory
- During the screwing, lock the metallic hexagon to avoid any stress on the PE part

- Moulded in PE100-RC

All dimensions are in millimeters and are intended as nominal and standard sizes: weights are in grams.
EUROSTANDARD reserves the right to change geometries and dimensions of any product.

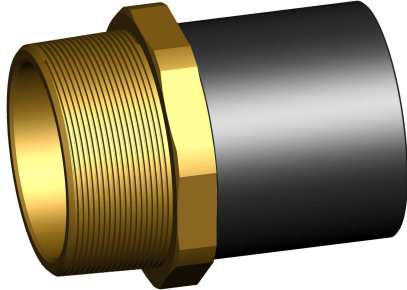
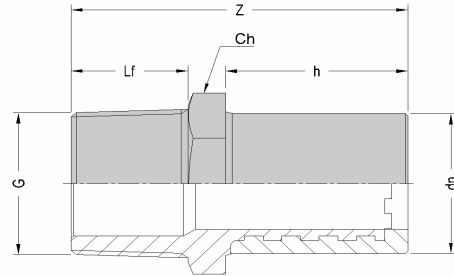
PRODUCT DETAILS

DIMENSIONS AND WEIGHT

ITEM	2177250075
dn [mm]	75
dn1 [mm]	
SDR	7,4
PN	25
MATERIAL	PE100
TRADEMARK	EURO
MANUFACTURING TYPE	INJECTION MOULDED
USE	WATER-GAS
QUANTITY PER BOX	1

dn	[mm]	75	
G	[mm]	2" 1/2	
Lf	[mm]	31	
h	[mm]	70	
Z	[mm]	113	
Ch	[mm]	86	

WEIGHT	[g]	1105
--------	-----	------

Tolerance: +/- 5% excluding dn

NOTE:

MARKING AND LABEL on fitting
STANDARDS AND APPROVALS

EN 12201
EN 1555
ISO 15494

INFOS

- Weldable with electrofusion EURO SDR11 and SD7.4 fittings, in case of use with other brand fittings, please contact Eurostandard in advance
- Extension of the metallic overmoulded part on the whole length
- Suitable for gas and water pipelines
- Measure and respect the insertion depth inside the electrofusion fitting
- Weld only using electrofusion fittings
- Scraping of the PE end is compulsory
- During the screwing, lock the metallic hexagon to avoid any stress on the PE part

- Moulded in PE100-RC

All dimensions are in millimeters and are intended as nominal and standard sizes: weights are in grams. EUROSTANDARD reserves the right to change geometries and dimensions of any product.

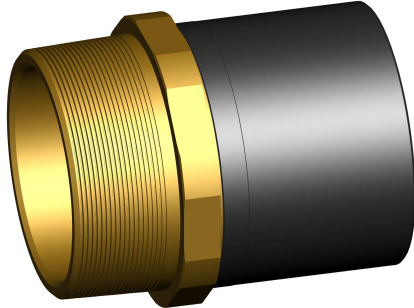
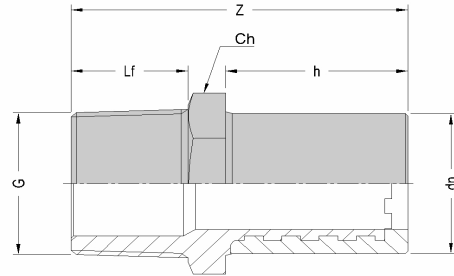
PRODUCT DETAILS

DIMENSIONS AND WEIGHT

ITEM	2177250090
dn [mm]	90
dn1 [mm]	
SDR	7,4
PN	25
MATERIAL	PE100
TRADEMARK	EURO
MANUFACTURING TYPE	INJECTION MOULDED
USE	WATER-GAS
QUANTITY PER BOX	1

dn	[mm]	90	
G	[mm]	3"	
Lf	[mm]	34	
h	[mm]	79	
Z	[mm]	125	
Ch	[mm]	97	
			WEIGHT [g] 1630

Tolerance: +/- 5% excluding dn

NOTE:

MARKING AND LABEL on fitting
STANDARDS AND APPROVALS

EN 12201
EN 1555
ISO 15494

INFOS

- Weldable with electrofusion EURO SDR11 and SD7.4 fittings, in case of use with other brand fittings, please contact Eurostandard in advance
- Extension of the metallic overmoulded part on the whole length
- Suitable for gas and water pipelines
- Measure and respect the insertion depth inside the electrofusion fitting
- Weld only using electrofusion fittings
- Scraping of the PE end is compulsory
- During the screwing, lock the metallic hexagon to avoid any stress on the PE part

- Moulded in PE100-RC

All dimensions are in millimeters and are intended as nominal and standard sizes: weights are in grams. EUROSTANDARD reserves the right to change geometries and dimensions of any product.

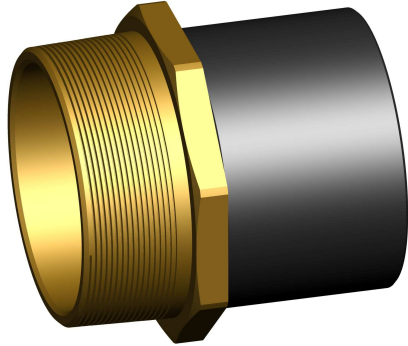
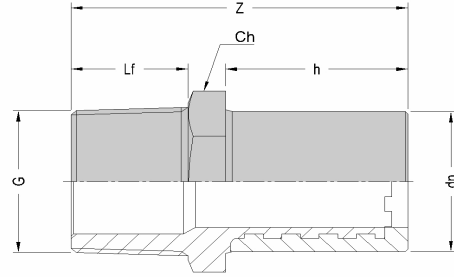
PRODUCT DETAILS

DIMENSIONS AND WEIGHT

ITEM	2177250110
dn [mm]	110
dn1 [mm]	
SDR	7,4
PN	25
MATERIAL	PE100
TRADEMARK	EURO
MANUFACTURING TYPE	INJECTION MOULDED
USE	WATER-GAS
QUANTITY PER BOX	1

dn	[mm]	110	
G	[mm]	4"	
Lf	[mm]	40	
h	[mm]	82	
Z	[mm]	134	
Ch	[mm]	125	

WEIGHT	[g]	2290
--------	-----	------

Tolerance: +/- 5% excluding dn

NOTE:

MARKING AND LABEL on fitting
STANDARDS AND APPROVALS

EN 12201
EN 1555
ISO 15494

INFOS

- Weldable with electrofusion EURO SDR11 and SD7.4 fittings, in case of use with other brand fittings, please contact Eurostandard in advance
- Extension of the metallic overmoulded part on the whole length
- Suitable for gas and water pipelines
- Measure and respect the insertion depth inside the electrofusion fitting
- Weld only using electrofusion fittings
- Scraping of the PE end is compulsory
- During the screwing, lock the metallic hexagon to avoid any stress on the PE part

- Moulded in PE100-RC

All dimensions are in millimeters and are intended as nominal and standard sizes: weights are in grams.
EUROSTANDARD reserves the right to change geometries and dimensions of any product.